

8032507

Press

FESTO

CP Factory / CP Lab
Application Modules

Data sheets

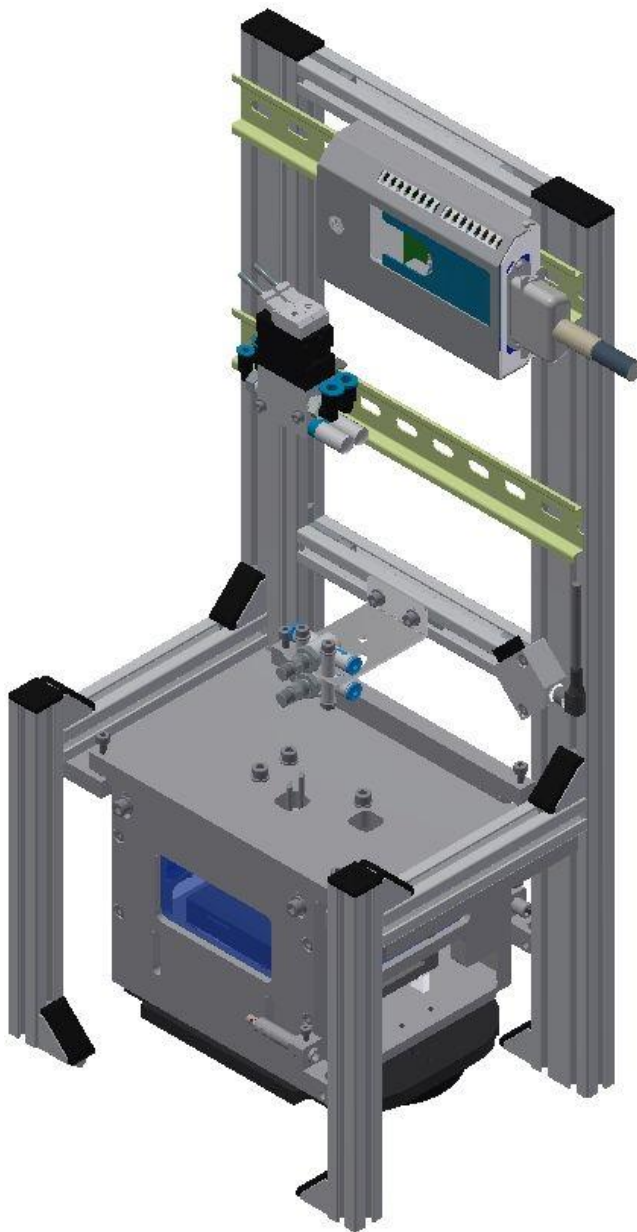

Data sheet: Proximity Sensor SME-8-K-LED-24 – #150855

Function

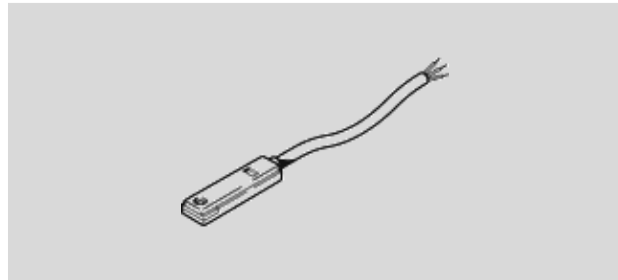
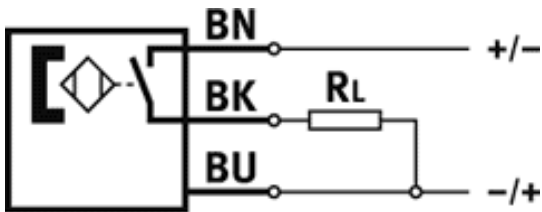

Feature	values
Design	for T-slot
Conforms to standard	EN 60947-5-2
Authorisation	C-Tick
CE mark (see declaration of conformity)	to EU directive for EMC
Materials note	Free of copper and PTFE Conforms to RoHS
Measuring principle	Reed magnetic
Ambient temperature	-40 ... 60 °C
Switch output	with contact, bipolar
Switching element function	Normally open contact
Reproducibility of switching value	+/- 0,1 mm
Switch-on time	≤ 0.5 ms
Switch-off time	0.03 ms
Max. switching frequency	800 Hz
Max. output current	500 mA
Max. contact rating AC	10 VA
Max. contact rating DC	10 W
Voltage drop	0 V
Short circuit strength	No
Overload withstand capability	Not available
Operating voltage range AC	12 ... 30 V
Operating voltage range DC	12 ... 30 V
Polarity protected	No
Electrical connection	Cable 3-core
Connector exit direction	axial
Cable length	2.5 m
Materials information, cable sheaths	PUR
Mounting type	Clamped in T-slot Insertable into slot lengthwise
Tightening torque	0.2 Nm
Product weight	30 g
Materials information, housing	Epoxy resin PC PET High alloy steel, non-corrosive
Operating status display	Yellow LED
Ambient temperature	-5 ... 60 °C
Protection class	IP65 IP67
Insulation voltage	50 V
Surge strength	0.8 kV
Degree of contamination	3

Data sheet: Connecting cable SIM-M8-4GD-2,5-PU – #158960

Function

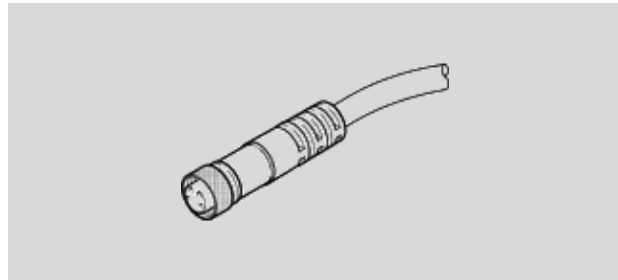
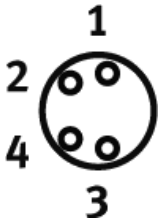

Feature	values
Conforms to standard	EN 61076-2-104 EN 61984
Cable attribute	Standard
Test conditions of cable	Chain link trunking: 5 million cycles, bending radius 75 mm Bending strength according to Festo standard Test conditions on request
Operating voltage range AC	0 ... 30 V
Operating voltage range DC	0 ... 30 V
Surge strength	1.5 kV
Acceptable current load at 40°C	3 A
Degree of contamination	3
Protection class	IP65 IP68
Ambient temperature	-5 ... 70 °C -25 ... 70 °C
Cable structure	4 x 0,25 mm ²
Cable diameter	4.5 mm
Cable length	2.5 m
Nominal conductor cross-section	0.25 mm ²
Colour code, core insulation	blue brown Black white
Housing colour	Black
Cable sheath colour	Grey
Materials information for locknut	Brass Nickel plated
Materials note	Free of copper and PTFE Conforms to RoHS
Materials information, housing	TPE-U(PU)
Material information, isolating sleeve	PVC
Materials information, cable sheaths	TPE-U(PU)

Data sheet: Fibre-optic unit SOEG-L-Q30-P-A-S-2L – #165327



Function

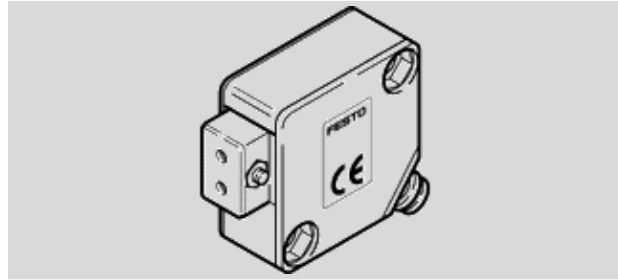
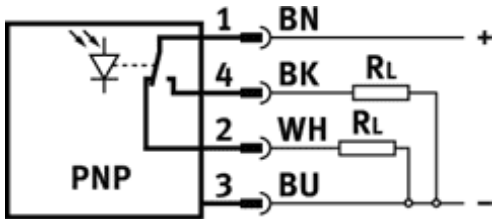

Feature	values
Conforms to standard	EN 60947-5-2
Authorisation	C-Tick c UL us - Listed (OL)
CE mark (see declaration of conformity)	to EU directive for EMC
Materials note	Free of copper and PTFE
Measurement method	Fibre-optic unit
Type of light	Red
Working range	0 ... 120 mm
Ambient temperature	-25 ... 55 °C
Switch output	PNP
Switching element function	Antivalent
Max. switching frequency	1,000 Hz
Max. output current	200 mA
Voltage drop	2 V
Short circuit strength	Pulsing
Operating voltage range DC	10 ... 30 V
Residual ripple	20 %
Idle current	25 mA
Polarity protected	for all electrical connections
Electrical connection	Plug M8x1 4-pin
Size	30x30x15 mm
Mounting type	with through hole
Product weight	18 g
Materials information, housing	PBT-reinforced
Operating status display	Yellow LED
Operating reserve display	Green LED
Setting options	Potentiometer
Upper limit of adjustment range	100 ... 400 mm
Setting range upper limit depends upon fibre-optics	100 mm for SOEZ-LLG-RT-0,5-M6 120 mm for SOEZ-LLK-RT-2,0-M6 280 mm for SOEZ-LLG-SE-0,5-M4 400 mm for SOEZ-LLK-SE-2,0-M4
Ambient temperature	-5 ... 55 °C
Protection class	IP65
Corrosion resistance classification CRC	2

Data sheet: Fibre-optic cable SOEZ-LLK-SE-2,0-M4 – #165360

Function

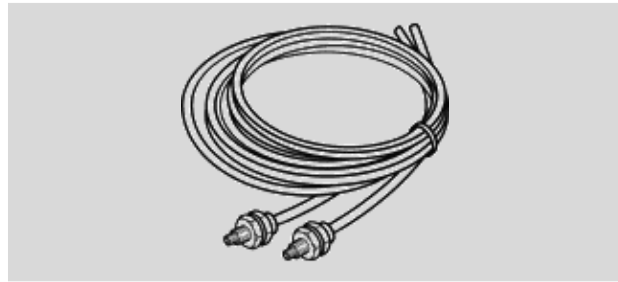

Feature	values
Measurement method	Through-beam sensor Fibre optics
Ambient temperature	-40 ... 70 °C
Size	M4
Product weight	20 g
Materials information, housing	PE
Upper limit of adjustment range	400 mm
Protection class	IP65

guided drive DFM-12-10-P-A-KF

Part number: 170899

★ Core product range

The proximity switch, type SMTSO-8E, is not suitable for this product.

With integrated guide.

FESTO

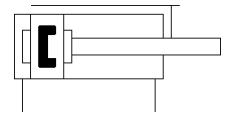
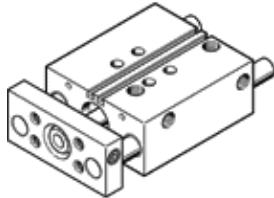

Data sheet

Feature	Value
Centre of gravity distance from working load to yoke plate	25 mm
Stroke	10 mm
Piston diameter	12 mm
Operating mode of drive unit	Yoke
Cushioning	P: Flexible cushioning rings/plates at both ends
Assembly position	Any
Guide	Recirculating ball bearing guide
Design structure	Guide
Position detection	For proximity sensor
Operating pressure	2 ... 10 bar
Max. speed	0.8 m/s
Mode of operation	double-acting
Operating medium	Compressed air in accordance with ISO8573-1:2010 [7:4:4]
Note on operating and pilot medium	Lubricated operation possible (subsequently required for further operation)
Corrosion resistance classification CRC	0 - No corrosion stress
Ambient temperature	-5 ... 60 °C
Impact energy in end positions	0.07 Nm
Max. torque Mx	0.55 Nm
Max. useful load as a function of the stroke at defined distance xs	27 N
Theoretical force at 6 bar, return stroke	51 N
Theoretical force at 6 bar, advance stroke	68 N
Moving mass	147 g
Product weight	320 g
alternative connections	See product drawing
Pneumatic connection	M5
Materials note	Free of copper and PTFE Conforms to RoHS
Materials information for cover	Wrought Aluminium alloy
Materials information for seals	NBR
Materials information, housing	Wrought Aluminium alloy
Materials information for piston rod	High alloy steel, non-corrosive

Data sheet: One-way flow control valve GRLA-M5-QS-4-LF-C – #175056

Function

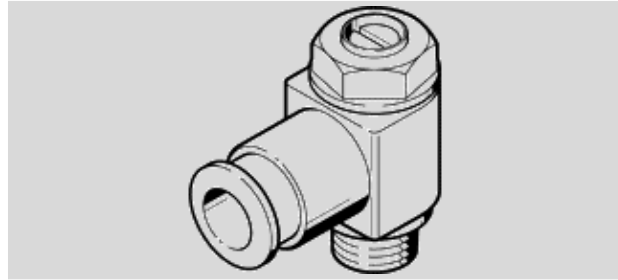
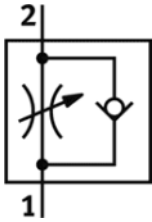

Feature	values
Valve function	One-way flow control function for exhaust air
Pneumatic connection, port 1	QS-4
Pneumatic connection, port 2	M5
Adjusting element	Slotted head screw
Mounting type	Threaded
Standard nominal flow rate in flow control direction	40 l/min
Standard nominal flow rate in non-return direction	50 ... 75 l/min
Operating pressure	0.2 ... 10 bar
Ambient temperature	-10 ... 60 °C
Operating medium	Compressed air in accordance with ISO8573-1:2010 [7:4:4]
Authorisation	Germanischer Lloyd
Assembly position	Any
Standard flow rate in direction of flow control: 6 -> 0 bar	80 l/min
Standard flow rate in blocked direction: 6 -> 0 bar	100 ... 150 l/min
Note on operating and pilot medium	Lubricated operation possible (subsequently required for further operation)
Medium temperature	-10 ... 60 °C
Max. tightening torque	1.5 Nm
Product weight	9 g
Materials information for screw-in stud	Nickel plated Brass
Materials information for seals	NBR
Release ring material data	POM
Regulating screw material data	Brass
Swivel joint material data	Zinc die-casting

Data sheet: Pressure sensor SDE5-... – #529027

Function

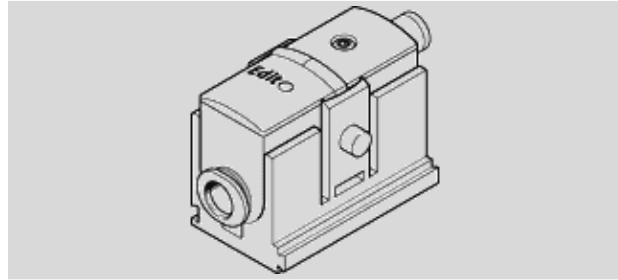

Feature	values
Authorisation	C-Tick c UL us - Recognized (OL)
CE mark (see declaration of conformity)	to EU directive for EMC
Materials note	Conforms to RoHS
Measured variable	Differential pressure Relative pressure
Measurement method	Piezoresistive pressure sensor
Pressure measuring range, initial value	-1 bar
Pressure measuring range, final value	10 bar
Operating medium	Compressed air in accordance with ISO8573-1:2010 [7:4:4]
Note on operating and pilot medium	Lubricated operation possible (subsequently required for further operation)
Medium temperature	0 ... 50 °C
Ambient temperature	0 ... 50 °C
Repetition accuracy in ± %FS	0.3 %FS
Temperature co-efficient in ± %FS/K	0.05 %FS/K
Switch output	NPN PNP
Switching function	Window comparator Freely programmable Threshold value with fixed hysteresis Threshold value with variable hysteresis
Switching element function	Normally closed contact Normally open contact Switchable
Max. output current	100 mA
Short circuit strength	Yes
Operating voltage range DC	15 ... 30 V
Polarity protected	for all electrical connections
Electrical connection	Cable Plug
Mounting type	with accessories
Assembly position	Any
Pneumatic connection	QS-1/4 QS-4 QS-5/32 QS-6
Materials information, housing	PA POM
Protection class	IP40
Corrosion resistance classification CRC	2

Data sheet: Adapter lens SASF-L1-LA-M2 – #552830

Function

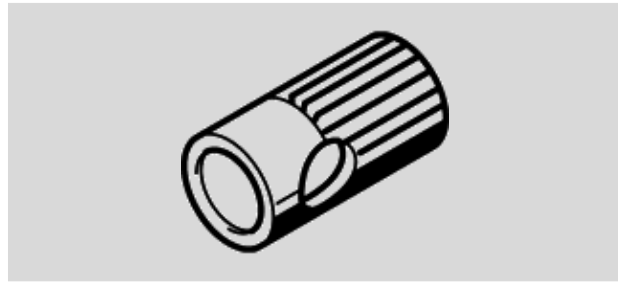

Feature	values
Ambient temperature	-30 ... 150 °C
Tightening torque	-0.2 ... 0.6 Nm
Product weight	0.7 g
Materials information, housing	Brass Nickel plated
Protection class	IP66
Corrosion resistance classification CRC	1
Lens element function	90° light exit